

HS2 ROUTE MAP

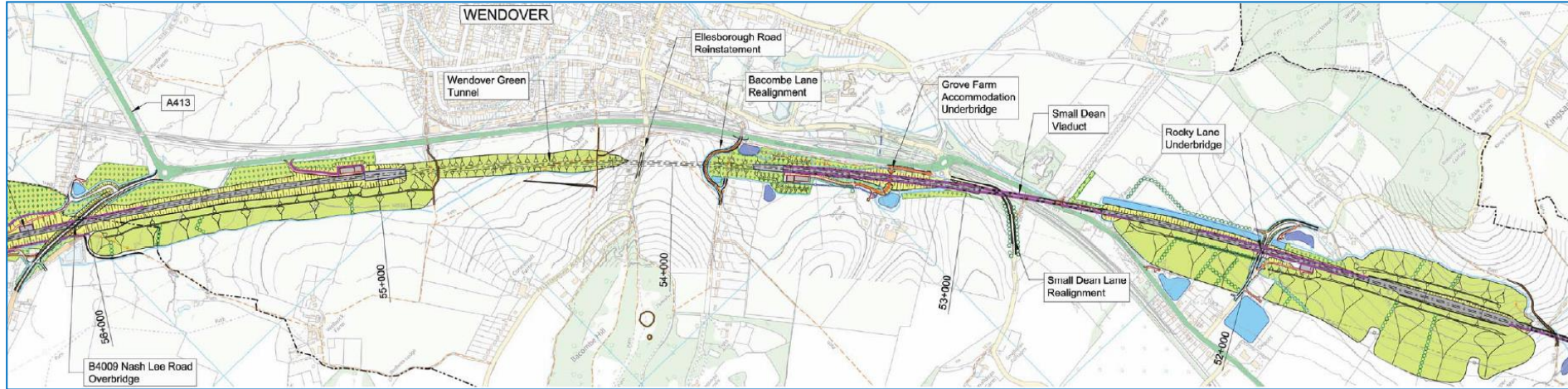

HS2 ROUTE - SIMPLIFIED TO SHOW MAIN FEATURES

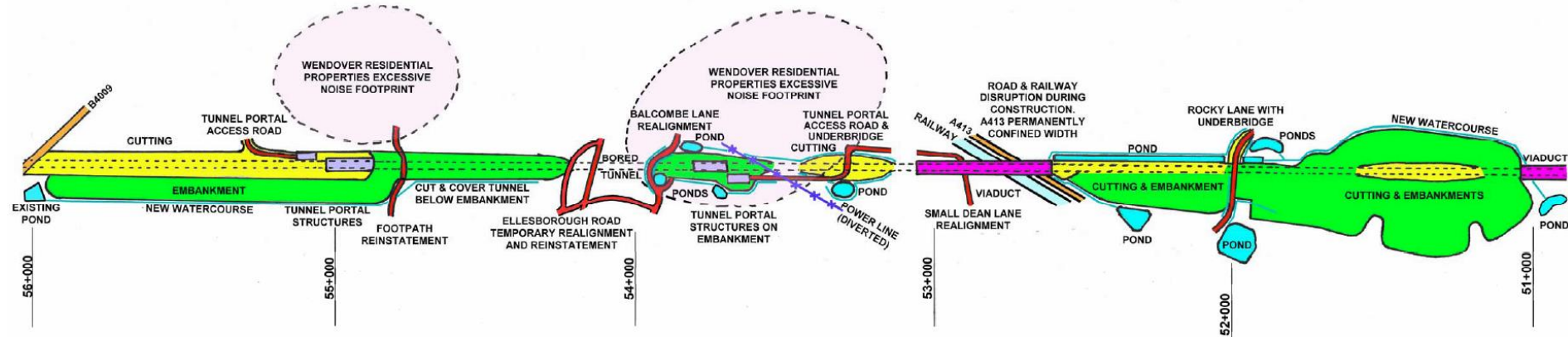

HS2 ALTERNATIVE TUNNELLED ROUTE



HS2 ALTERNATIVE ROUTE ENTIRELY IN TUNNEL – SIMPLIFIED TO SHOW MAIN FEATURES

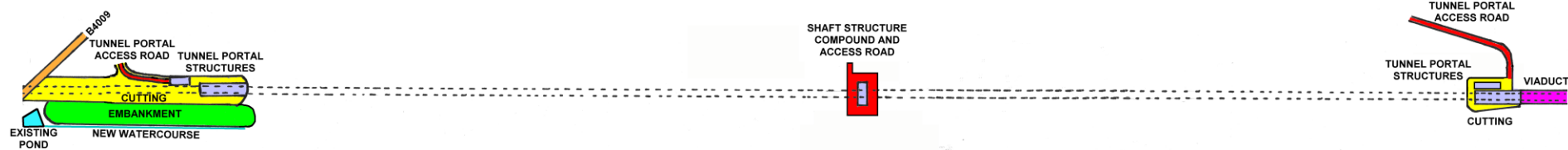

HS2 ROUTE

ESTIMATED CONSTRUCTION COST: £557 million
 ESTIMATED CONSTRUCTION PERIOD: 260 weeks
 ESTIMATED 25 YEAR LIFE CYCLE COST: £11 million per year

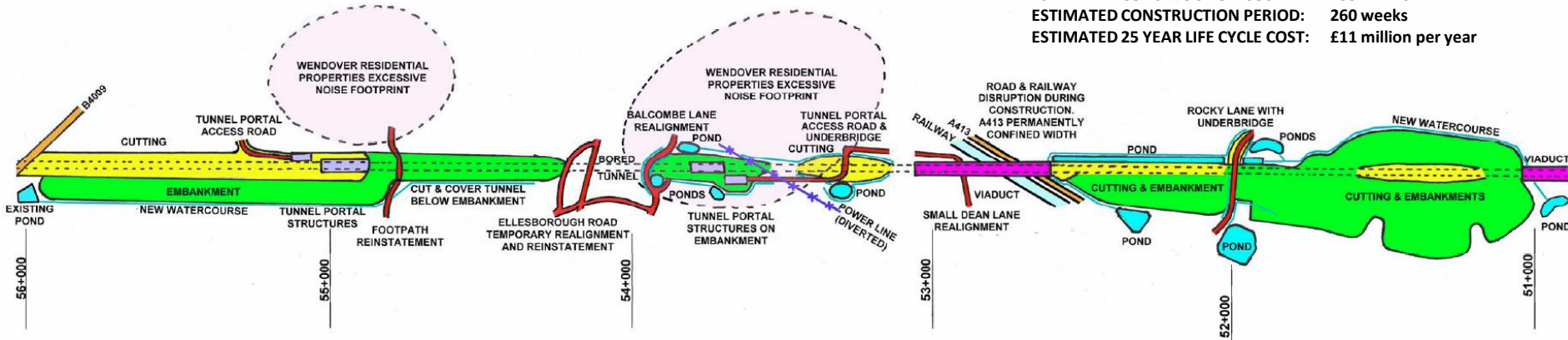

HS2 ALTERNATIVE ROUTE ENTIRELY IN TUNNEL

ESTIMATED CONSTRUCTION COST: £233 million
 ESTIMATED CONSTRUCTION PERIOD: 156 weeks
 ESTIMATED 25 YEAR LIFE CYCLE COST: £4.5 million per year

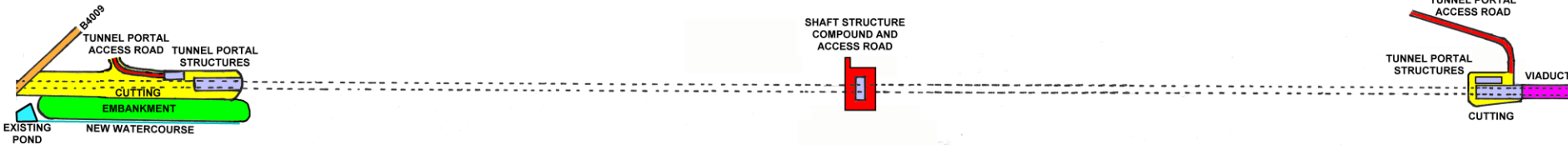

ESTIMATED CONSTRUCTION COSTS BASED ON:

"Rail Method of Measurement" (RMM) Volume 1 - Cost Planning, published by Network Rail in July 2014, end of 4th Quarter 2015. Prepared by mbpc Infrastructure Limited.

ESTIMATED CONSTRUCTION PERIOD BASED ON:

OTB Engineering Ltd, Report No. UK16035L R04. HS2 Phase 1 (London –West Midlands) Bill: Wendoover Petition. Mined Tunnel Scheme Alternative. January 2019.

ESTIMATED 25 YEAR LIFE CYCLE COST BASED ON:

Standardized Method of Life Cycle Costing for Construction Procurement" - a supplement to BS ISO 15686-5 Buildings and constructed assets - Service life planning - Part 5: Life cycle costing - ISBN 978-0-580-62662-3 published in 2008 by BSI, 389 Chiswick High Road, London W4 4AL. Prepared by mbpc Infrastructure Limited.